

SPECIFICATION:

L.O.A 63'-2" (19.25M)
 Hull Length 62'-0" (18.90M)
 Max.Beam (including moulded rub rail)..... 18'-0" (5.49M)
 Fuel Tank Capacity..... 1,300 US. Gals (4,921Lts)
 Fresh Water Tank Capacity..... 300 US. Gals (1,136Lts)

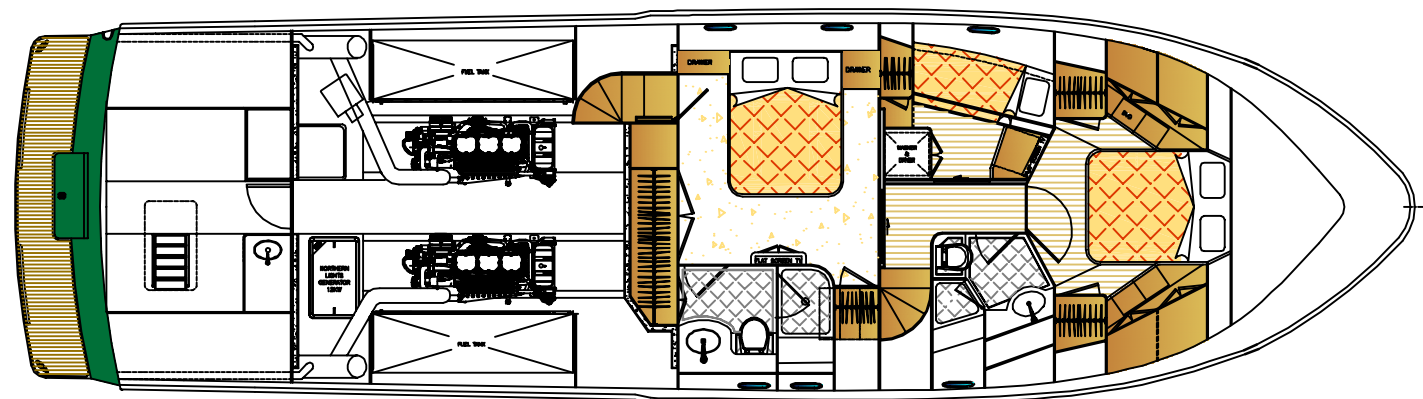
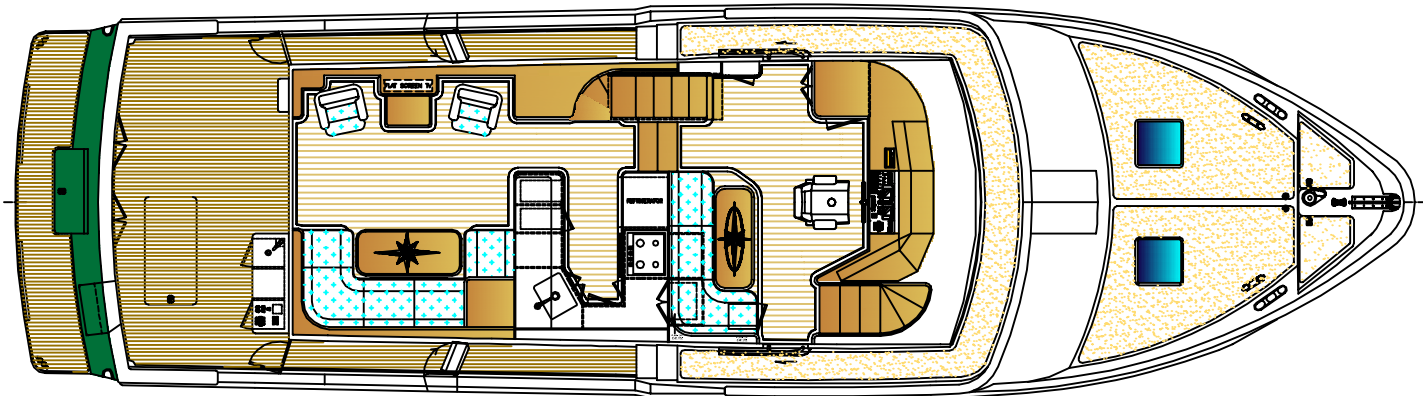
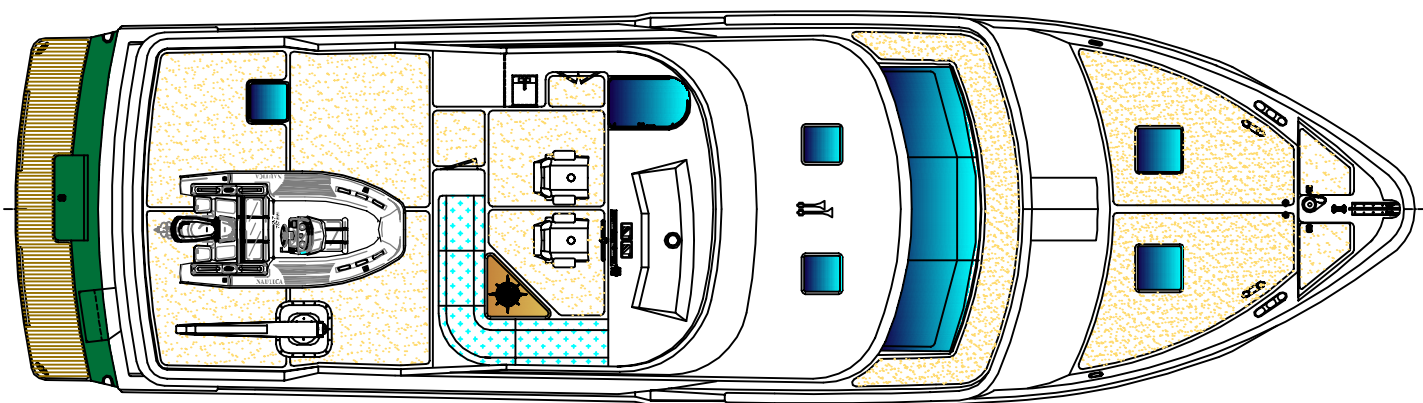

President 620 Pilothouse

ALL SPECIFICATIONS & EQUIPMENT SUBJECT TO CHANGE WITHOUT NOTICE
DRAWINGS MAY SHOW OWNER OR DEALER INSTALLED OPTIONS

THIS DRAWING AND THE INFORMATION CONTAINED HEREON IS AND REMAINS THE PROPERTY OF PRESIDENT BOAT INTERNATIONAL CO., LTD. ITS REPRODUCTION IN ANY WAY OR USE FOR ANY PURPOSE OTHER THAN THAT INTENDED IS EXPRESSLY FORBIDDEN

Profile & General Arrangement

Drawing No.: P620PH-001

Date: Nov. 30, 2009

President Boat International Co., Ltd. Taiwan